



210 Elite Telephone

User`s manual

This manual is made in order to familiarize you with your phone. In order to get maximum benefits of this product. we suggest that you read the User's Manual carefully before using your phone.

Phone Feature's

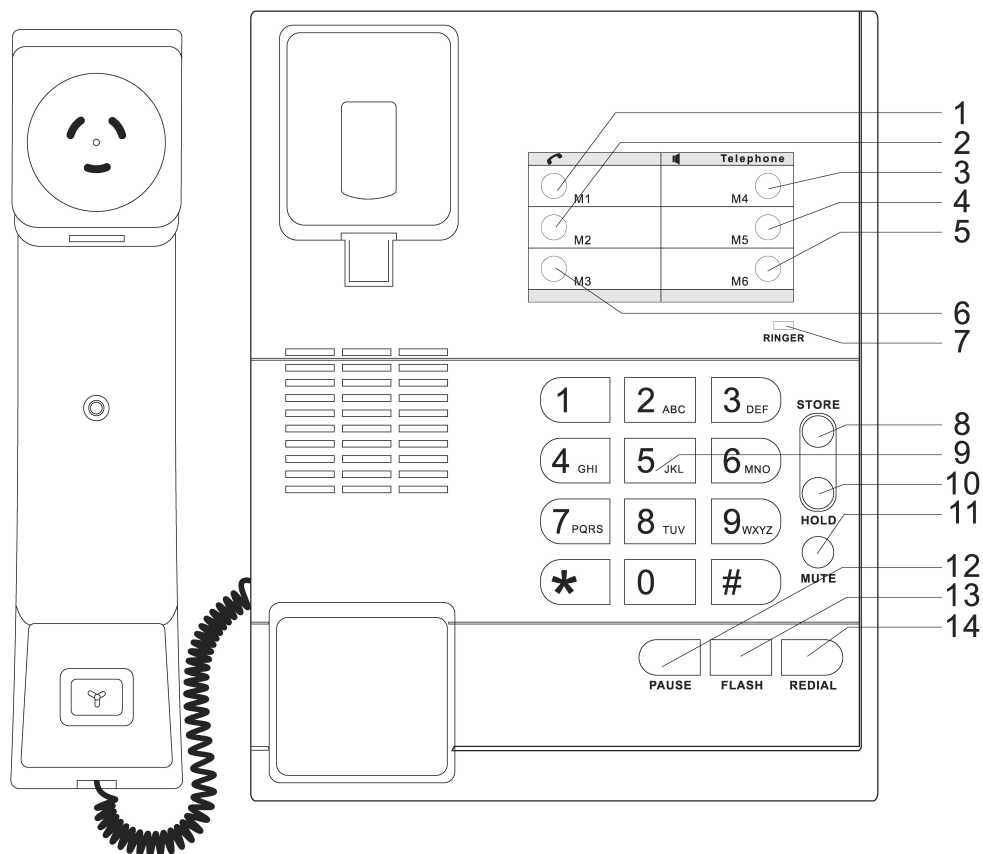

- 1-6 One Touch Memory Keys
- 7 Ringer / Message Light
- 8 Store Key
- 9 Dial Pad
- 10 Hold Key
- 11 Mute Key
- 12 Pause Key
- 13 Flash / Transfer Key
- 14 Last Number Redial Key

Installation

- 1) Please ensure the phone is installed in a dry, ventilated place.
- 2) Connect Coiled Handset cord to handset and plug other end into phone base.
- 3) Using the straight line lead, connect the phone to the Telecom port.
- 4) Pick up the handset and you will hear Dial Tone from the Telecom Network or PABX.
- 5) The phone is ready for use.

Package Items

Phone Base	Handset	Handset cable	Straight line cable	User's manual
1	1	1	1	1

Phone Functions

1. HOLD

During phone conversation and you need to put the other side on hold, you can press the HOLD button. The caller will hear music playing from your side. You can place the handset back on the phone base. The Hold function will turn off when you press the HOLD button again or pick up the handset.

2. MUTE

During conversation, and you don't want the other side hear from you, you can press MUTE button and hold. The function will be off when you release the button.

3. PAUSE

During dialing, you can press pause key to make the next number have a 3 second delay, this function can be used under certain public telephone exchanges or PABX systems.

4. FLASH

This key is used in conjunction with Telecom Centrex or PABX systems, it is used to transfer calls. The FLASH time is set to 600ms.

5. REDIAL

Pick up the handset press the REDIAL to dial out the last dialed number.

6. ONE TOUCH MEMORIES

To Store: With the Handset on hook, press the STORE button and then dial the numbers you want to save, then press the one touch memory button you want number store at (M1~M6), number is now stored.

To Use : Pick up the handset and press button (M1~M6)

7. RINGER VOLUME

Slide the RINGER SWITCH to 'LO' or 'HI' position; you can adjust the volume of the ringer for incoming calls.

IMPORTANT SAFETY INSTRUCTIONS

When using your telephone equipment, basic safety precautions should always be followed to reduce the risk of fire, electric shock and injury to persons, including the following:

1. Read and understand all instruction.
2. Follow all warning and instructions marked on the product
3. Unplug this product from the wall outlet before cleaning. Do not use liquid or aerosol cleaners. Use a damp cloth (not wet) for cleaning.
4. Do not use this product near water, for example, near a bath tub, wash bowl, kitchen sink, or laundry tub, in a wet basement, or near a swimming pool.
5. Do not place this product on an unstable cart, stand, or tables. The product may fall, causing serious damage to the product.
6. Slots and openings in the enclosure and the back or bottom are provided for ventilation to prevent overheating. These openings must not be blocked or covered. The openings should never be blocked by placing the product on a bed, sofa, rug or other similar surface. This product should never be placed near or over a radiator or heat register and should not be placed in a built-in installation unless proper ventilation is provided.
7. Never push objects of any kind into this product through enclosure slots as they may touch voltage points or short out parts that could result in a risk of fire or electric shock. Never spill liquid of any kind on the product.
8. Do not disassemble this product; take it to a qualified service technician or may expose you to voltage or other risks. Incorrect re-assembly can cause electric shock when the appliance is subsequently used.
9. Unplug this product from the wall outlet and refer to qualified service personnel under the following conditions:
 - a. When the power supply cord or plug is damaged or frayed.
 - b. If liquid has been spilled into the product.
 - c. If the product has been exposed to rain or water.
 - d. If the product does not operate normally by following the operating instruction. Adjust only those controls that are covered by the operating instructions. Improper adjustment of other controls may result in damage and may require extensive work by a qualified technician to restore the product to normal operations.
 - e. If the product has been dropped or the enclosure has been damaged.
 - f. If the product exhibits a distinct change in performance.
10. Avoid using a telephone during an electrical storm. There may be a remote risk of electric shock from lightning.
11. Do not use the telephone to report a gas leak in the vicinity of a leak.
12. Never install telephone wiring during a lightning storm.
13. Never install telephone jacks in wet locations unless the jack is specifically designed for wet locations.
14. Never touch un-insulated telephone wires or terminals unless the telephone line has been disconnected at the network interface.
15. Use caution when installing or modifying telephone lines.

Note Telepermit

The grant of a Telepermit for any item of terminal equipment indicates only that Telecom has

accepted that the item complies with the minimum conditions for connection to its network. It indicates no endorsement of the product by Telecom, nor does it provide any sort of warranty. Above all, it provides no assurance that any item will work correctly in all respects with another item of Telepermitted equipment of different make or model, nor does it imply any product is compatible with all of Telecoms Network services.

Telepermitted equipment only may be connected to the "Data" port. The Data port is not specifically designed for 3-wire-connected equipment. 3-wire-connected equipment might not respond to incoming ringing when attached to this port.

This device may be subject to ringing or bell tinkle when certain other devices are connected to the same line. If this occurs, the problem should not be referred to the Telecom Faults Service.